



Superior Magnetics Since 1979



CM-DBX

“Direct Box” Transformer 12 : 1 Step-down

- **Converts unbalanced line levels to balanced mic level**
- **Feed long cables without high frequency loss problems**
- **Helps to eliminate hum problems in musical instrument hookups**
- **Very Good CMRR: 105 dB at 60 Hz, 89 dB at 1 kHz**
- **Very wide bandwidth and low phase shift**
- **PC mount and lead packages**

The CineMag CM-DBX “Direct Box” transformer provides an excellent solution for the problem of controlling hum and buzz with feeds from musical instruments. It can be driven from moderately high impedance as well as lower impedance sources. It exhibits excellent bandwidth, very low phase shift, very good common mode rejection ratio (CMRR), and very good distortion characteristics. It is available in both lead and p.c. mount packages. The CM-DBX is encased in a μ Metal can which provides 30 dB of magnetic shielding. All the wires connecting the internal foil shields between windings are spot welded for maximum long term reliability, as is done with all CineMag transformers.

CM-DBX[PC]

| Parameter | Conditions | Typ |
|---|--|---|
| Turns Ratio | | 11.52 : 1 |
| Voltage Gain | 1 kHz, +4 dBu, 6.8K source impedance, 1K secondary load impedance | -22 dB |
| Distortion (THD+N%) | 1 kHz, +12.5 dBu Test Circuit 1 20 Hz, +4 dBu Test Circuit 1 | 0.0015% 0.04% |
| Max 20 Hz input level | 1.0% THD; 6.8K source impedance, 1K secondary load impedance. Test Circuit 1 | +21.5 dBu |
| Response, ref 1 kHz | 20 Hz +4 dBu Test Circuit 1 20 kHz +4 dBu Test Circuit 1 -3 dB | -0.1 dB -0.01 dB 150 kHz |
| Phase Shift at 20 Hz Phase Shift at 20 kHz | Referenced to source generator Test Circuit 1 | +3° -13° |
| CMRR | 60 Hz Test Circuit 2 per IEEE Std 389-1996 ¶19 1 kHz Test Circuit 2 per IEEE Std 389-1996 ¶19 | 105 dB 89 dB |
| Operating Temp Range | Operation and storage | 0° C Min 70° C Max |
| Max Soldering Temp. | 5 Seconds | 335°C Max |

9050 Independence Ave. Canoga Park, California 91304

☎(818) 993-4644 ☒(818) 993-4604

<http://www.cinemag.biz>

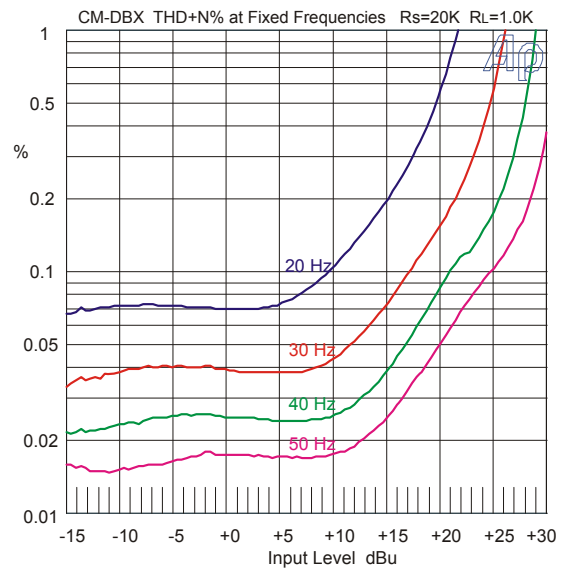
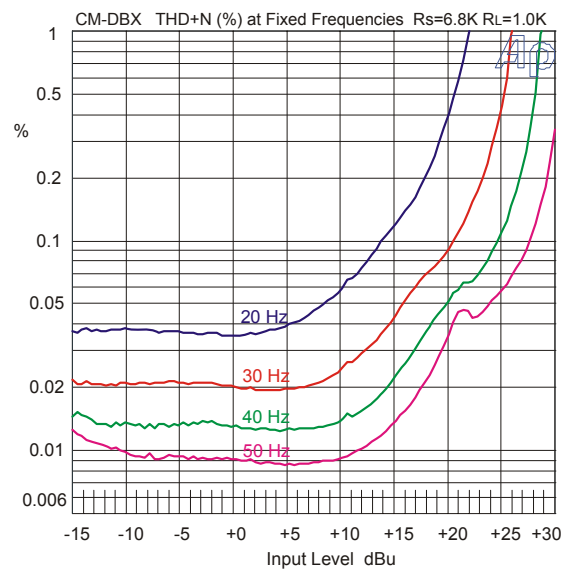
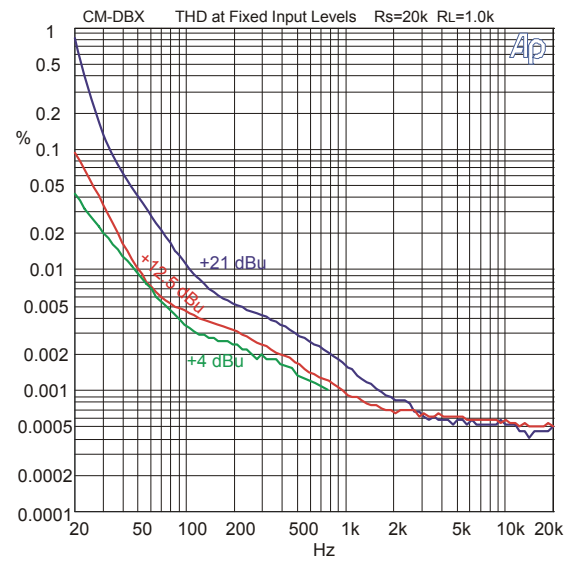
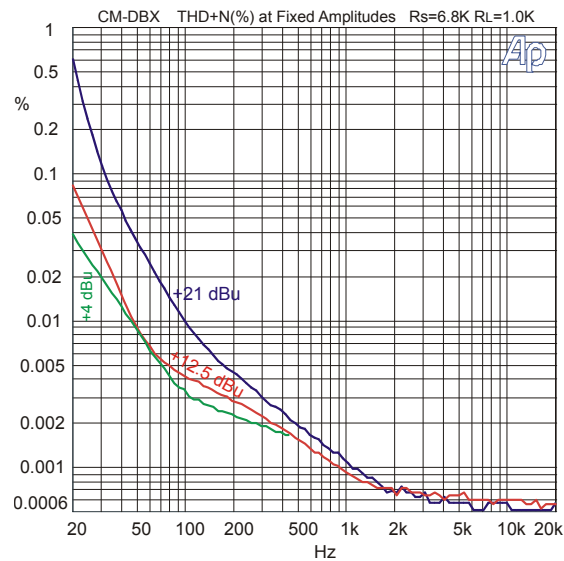
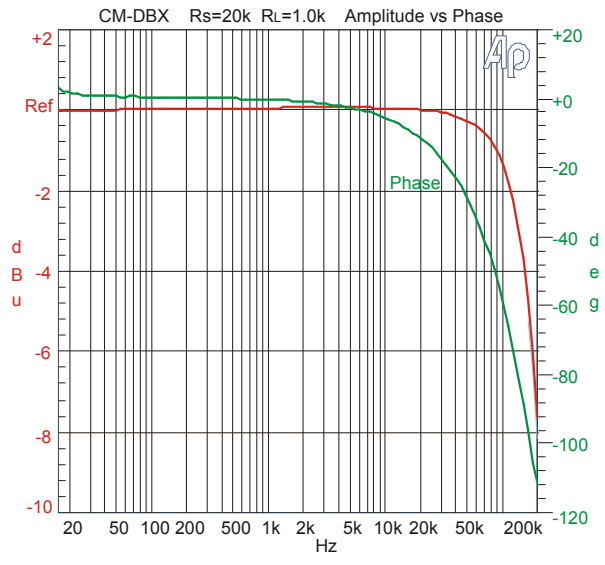
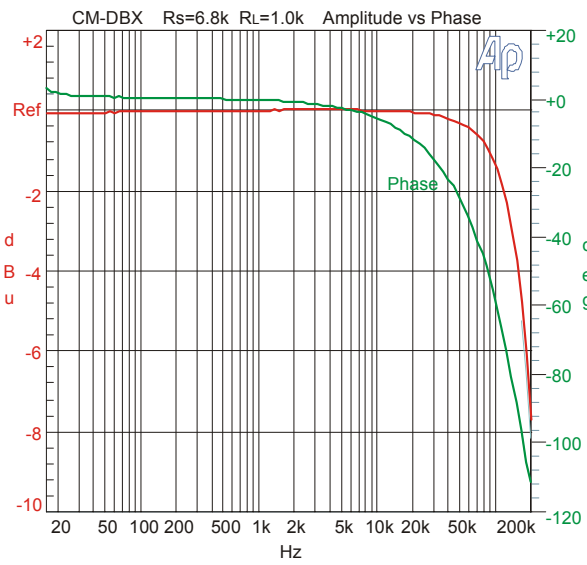

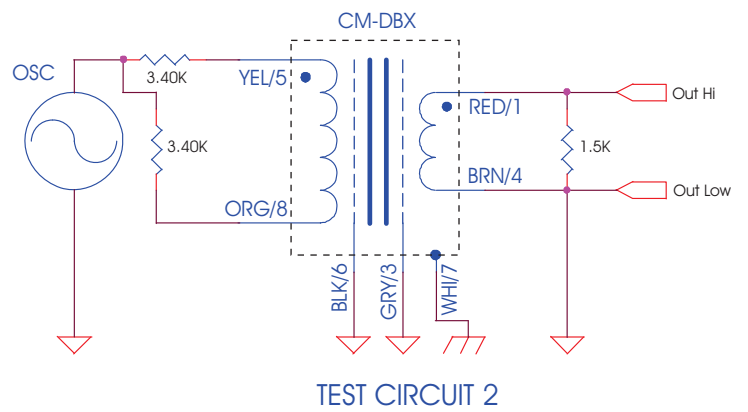
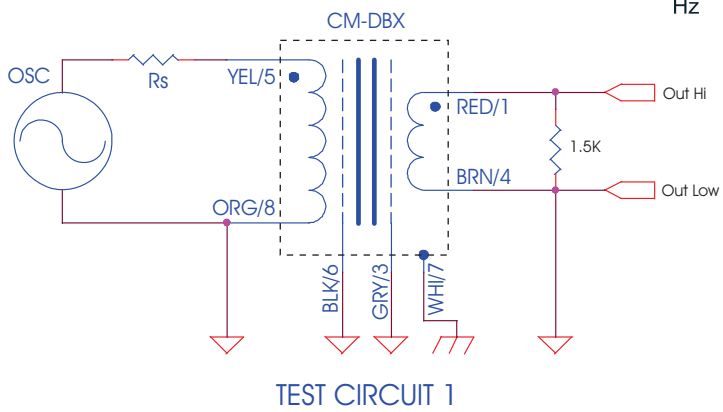
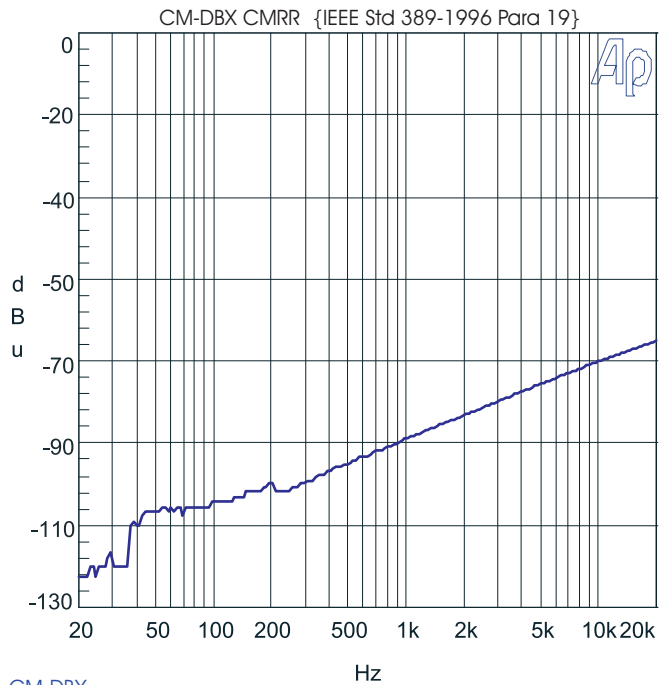

NOTES:

1. All graphs generated from one (1) randomly chosen device. No statistical averaging or weighting. Data from one sweep.

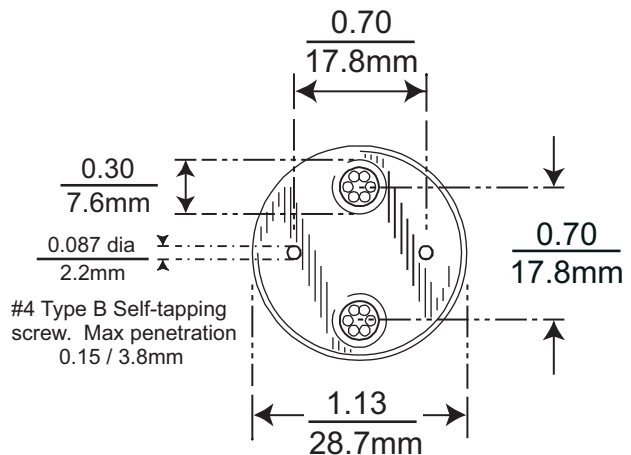
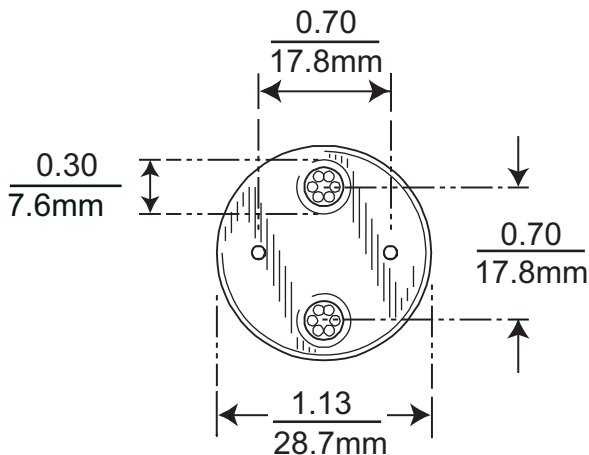
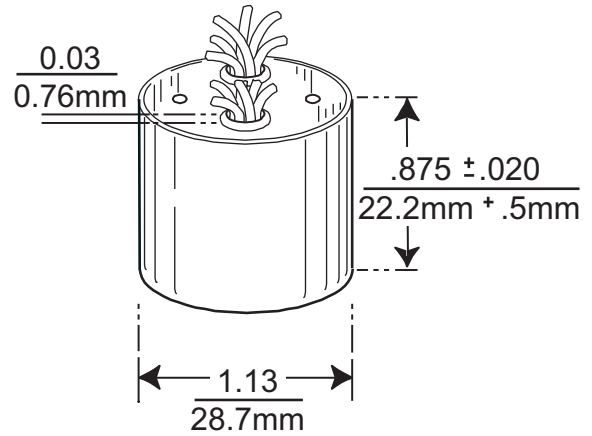
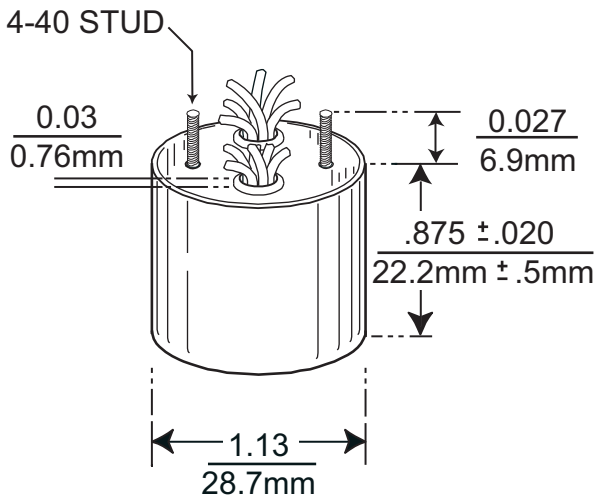
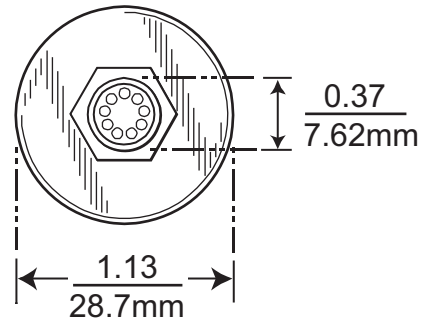
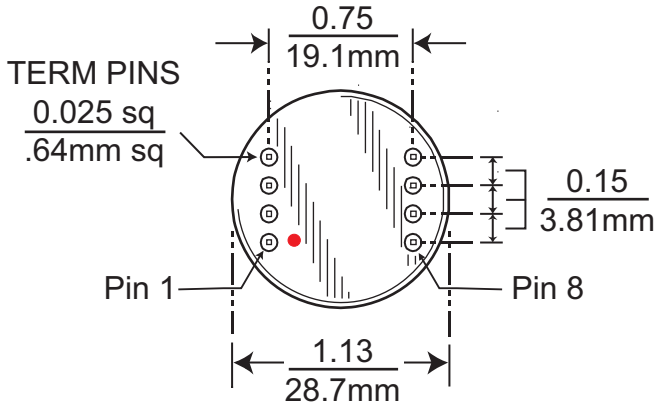
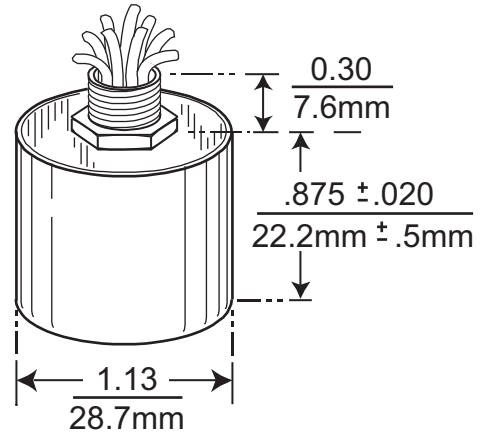
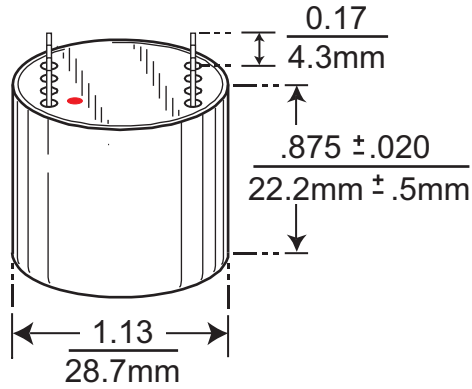

#4 Type B Self-tapping screw. Max penetration 0.15 / 3.8mm